

# UNITY 2.2

Sit-Stand Bench Desk

FP-FM-02.0001-WT

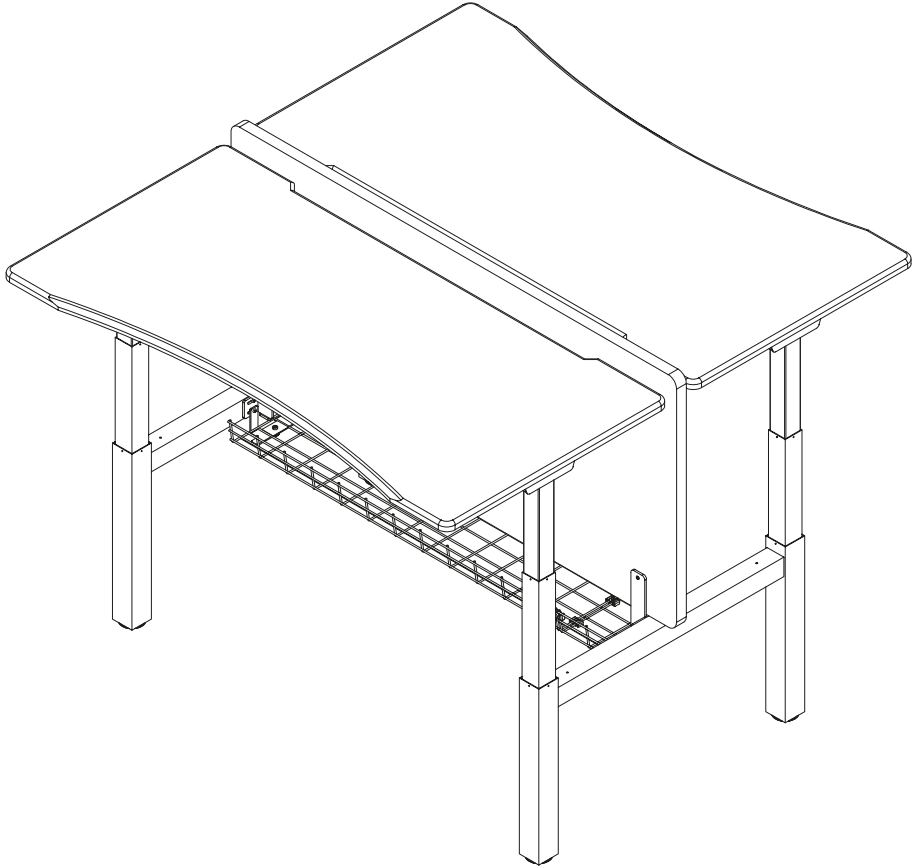

## IMPORTANT SAFETY INFORMATION

1. Keep Hands clear of moving parts during operation and always visually inspect the area before adjusting the desk to avoid accidents and damage to property.



### **WARNING!**

**Pinch point.** Keep hands clear during operation.



2. Make sure no obstacles are in the desks movement path and all the cords connected to the desk are the appropriate length to accommodate the change in height.
3. Keep children away from the desks electrical components and ensure children are supervised while using the desk.
4. Keep all electrical components away from liquids.
5. Do NOT sit or stand on the desk frame or go under the desk when in motion.
6. Do NOT place any objects taller than 550mm under the desk.
7. Do not open or tamper with any of the electrical components (Legs, Control panel, Control Box and Power cable).

**Height adjustable desks have electronic motors and control gear and are designed for use in dry work areas ONLY.**

# CONTENTS

## BOX 1

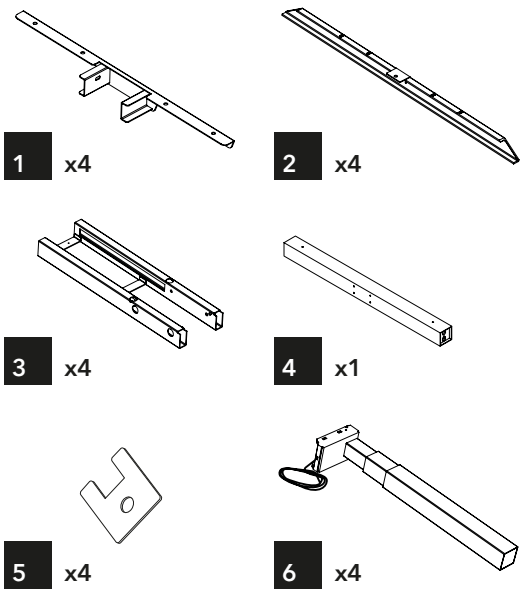

## BOX 2

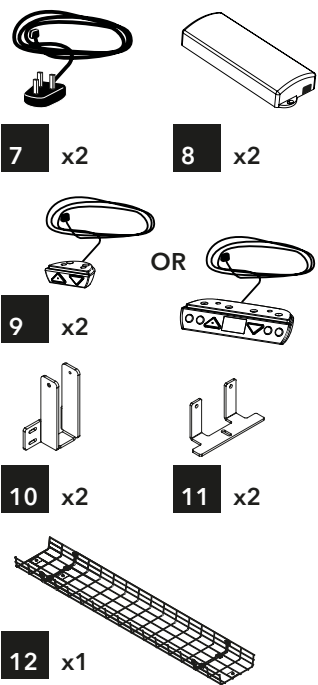

**BOX 3:** Table Tops if supplied.

## FIXINGS

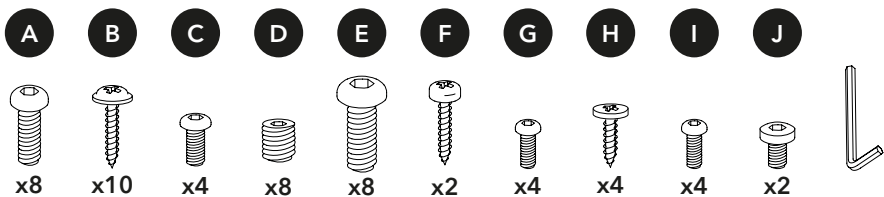

## ADDITIONAL ITEMS REQUIRED

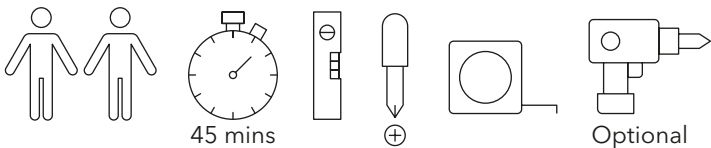

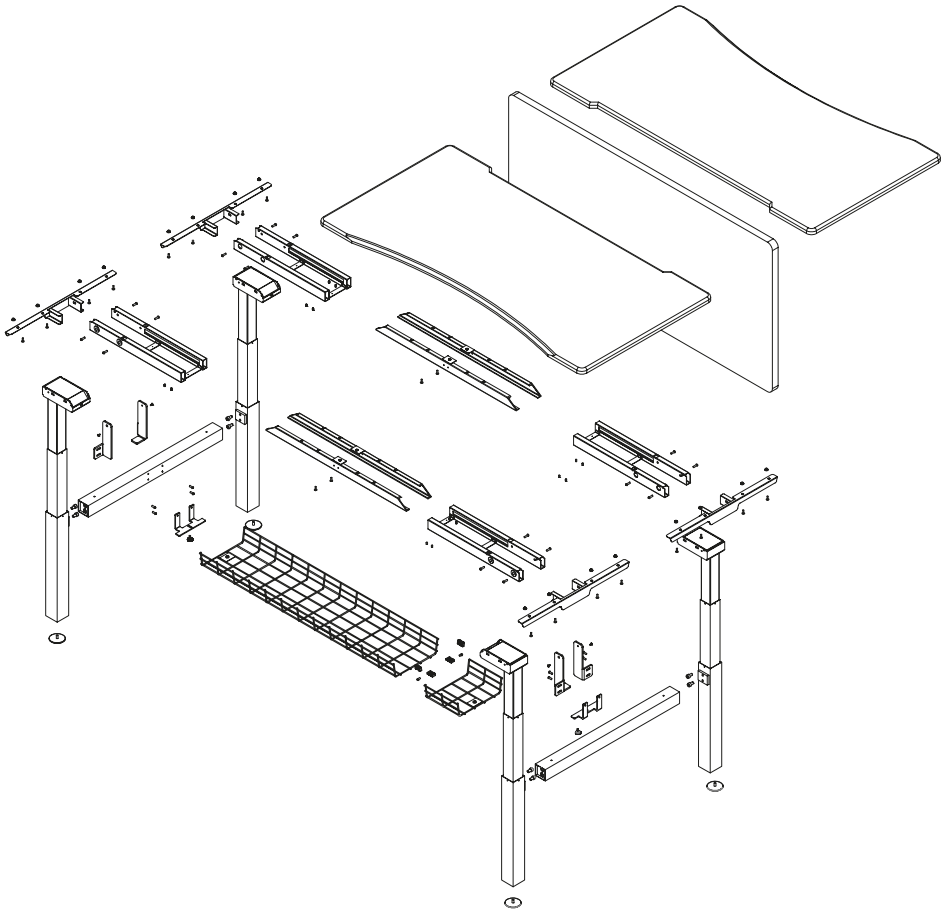

For User Manual and assembly videos,  
please visit: [www.smart2ergo.com/resources](http://www.smart2ergo.com/resources)

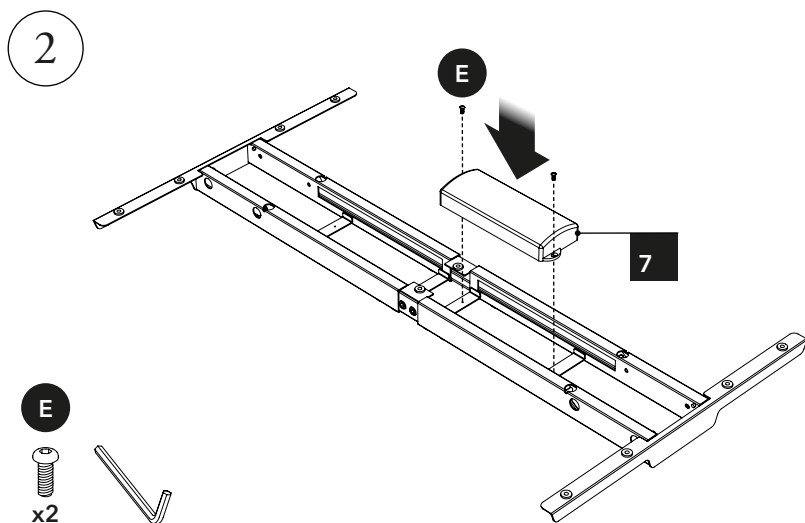
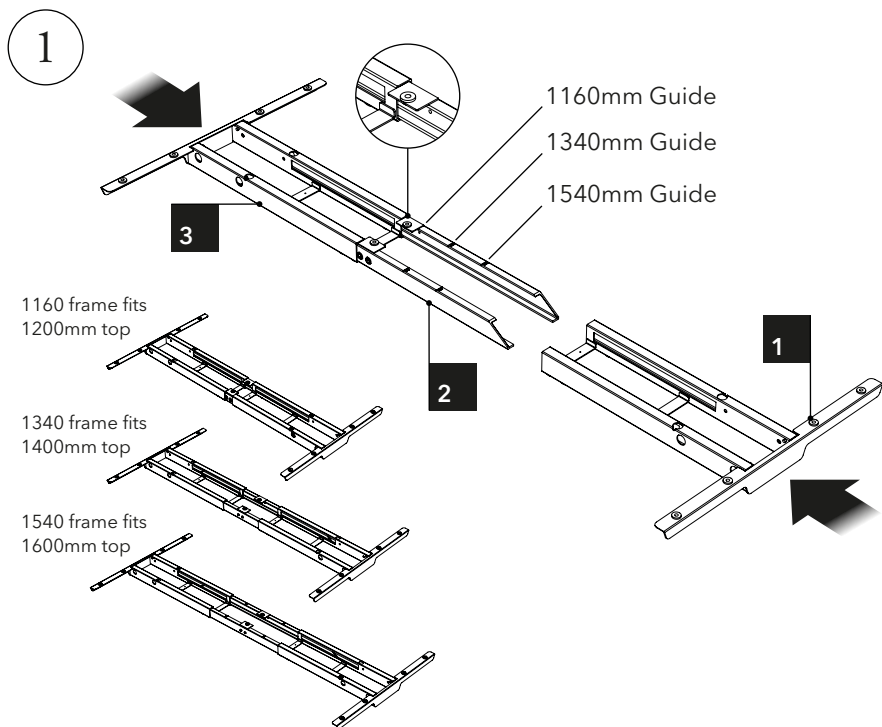

3

Cable MUST  
be completely  
inside slot!

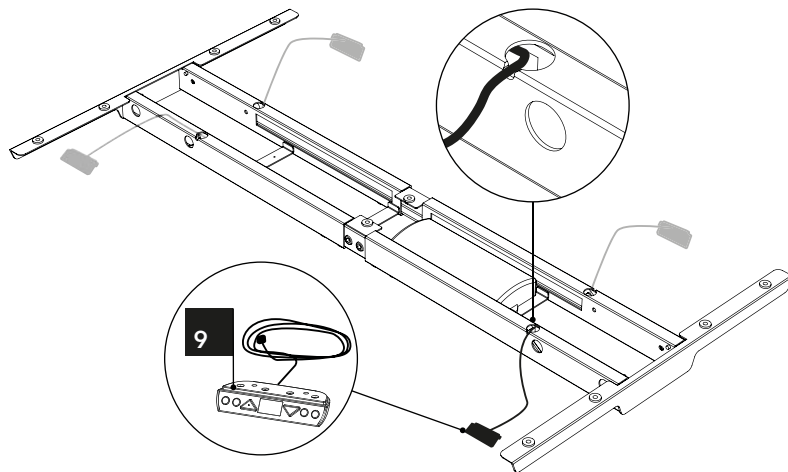
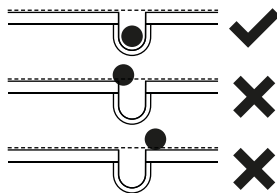

4

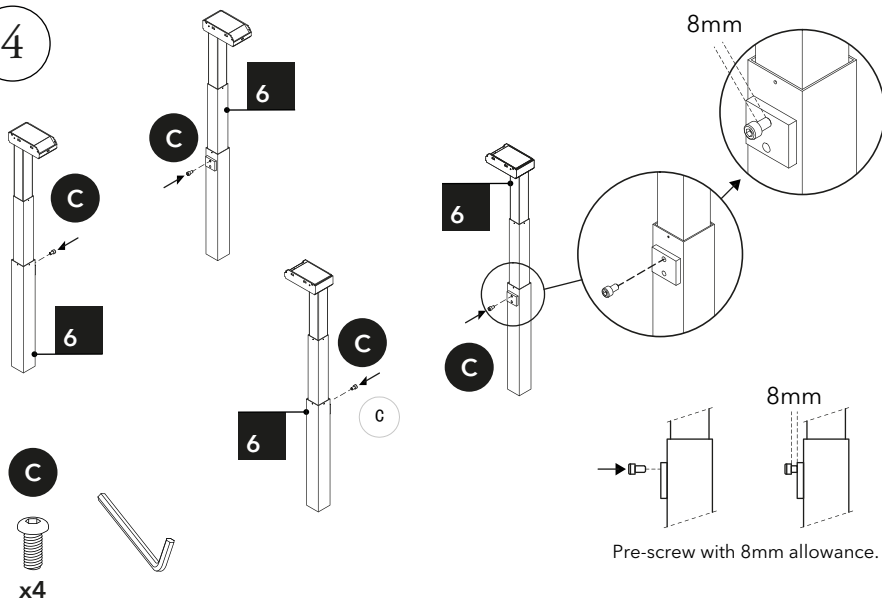

5

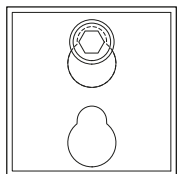
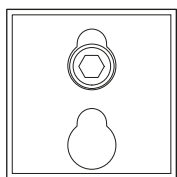
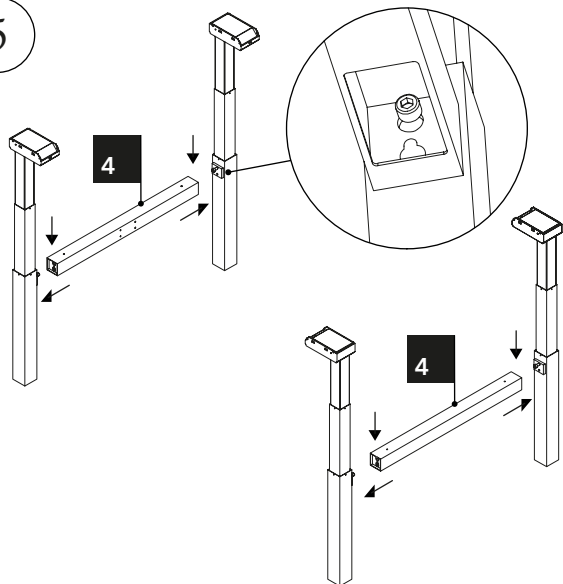

6

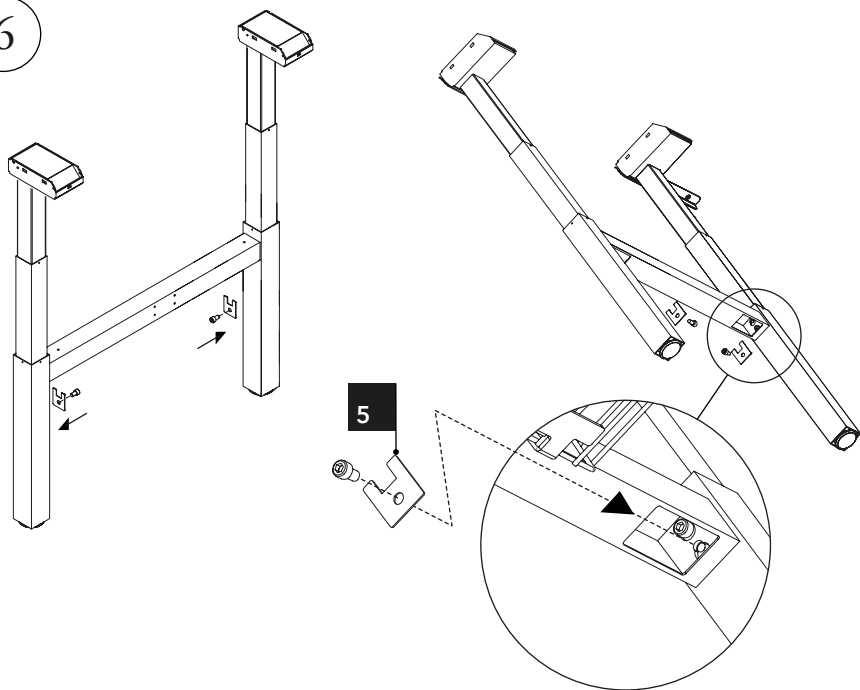

7

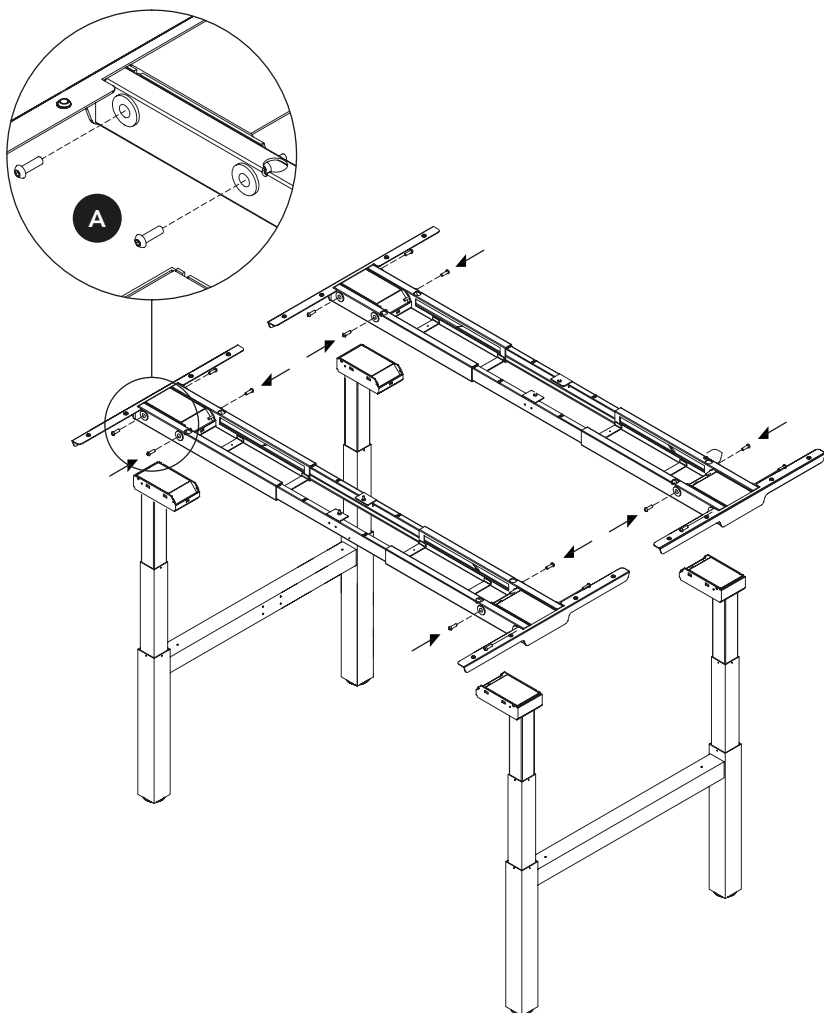

A

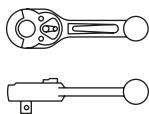
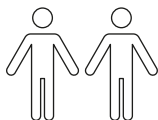
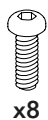

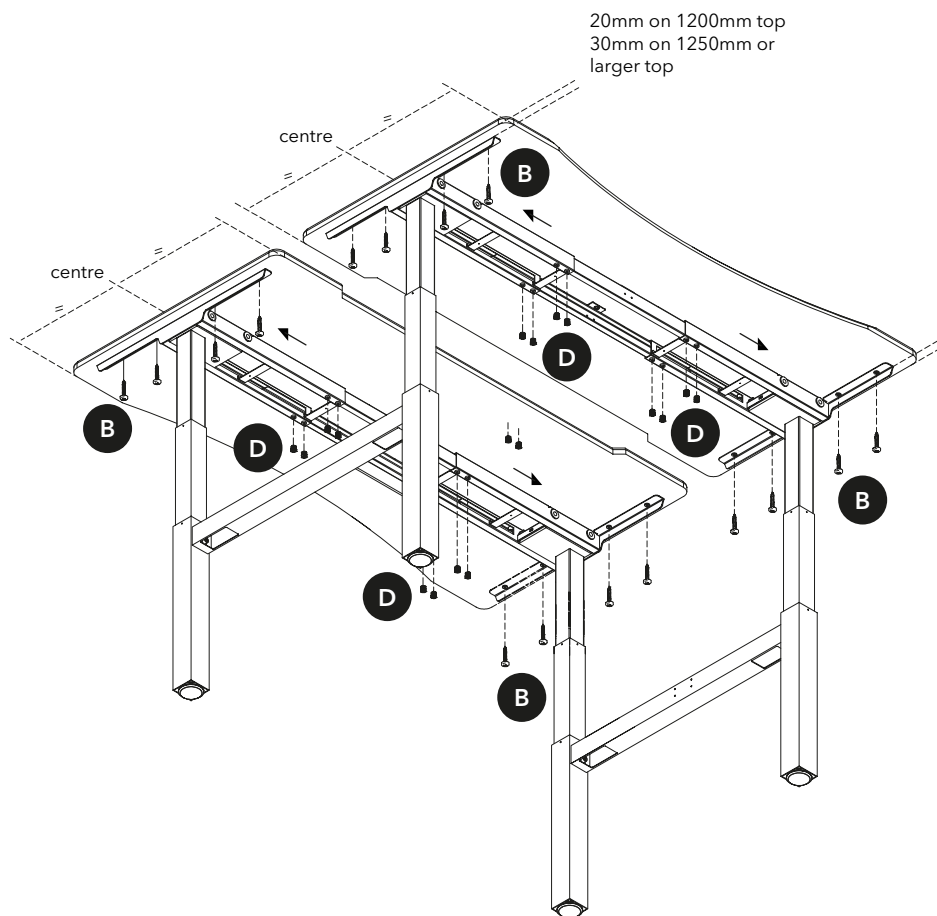
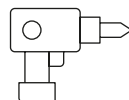
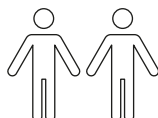

**B****D****x16****x16**

Optional

9

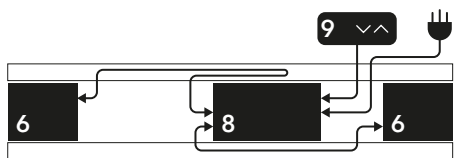
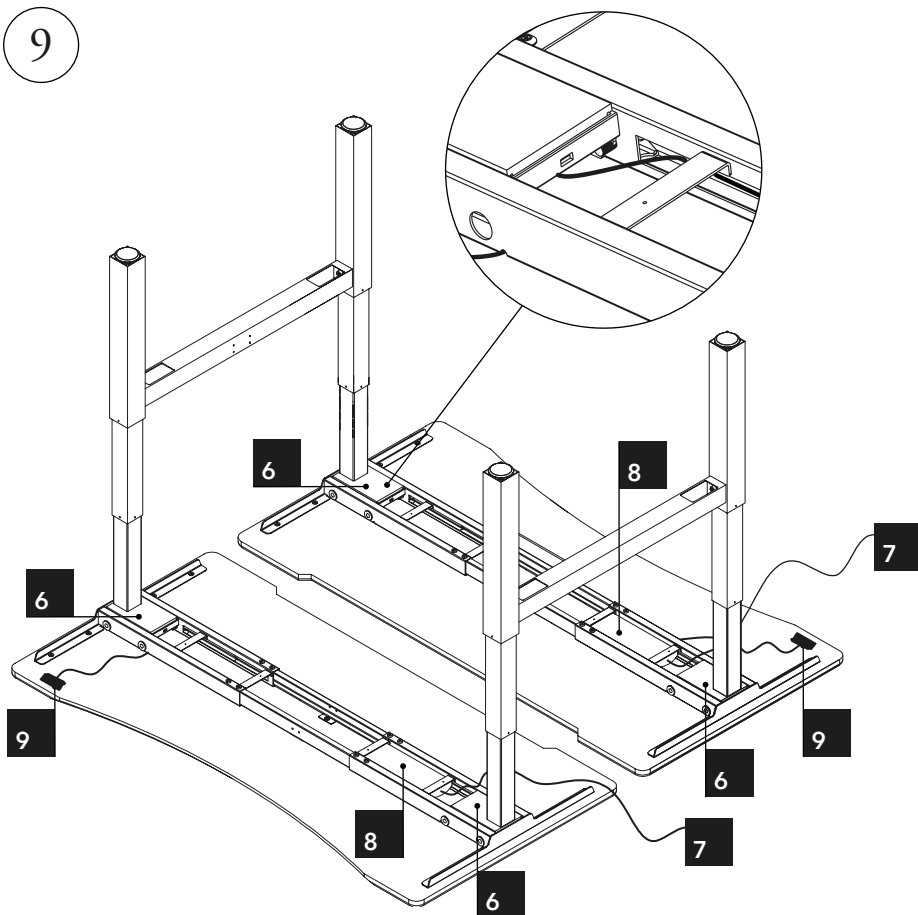

Feed Cables Through Frame

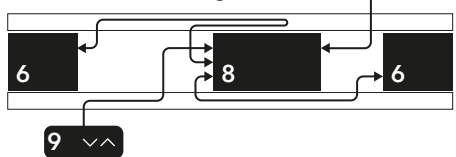

DO NOT PLUG  
INTO POWER

10

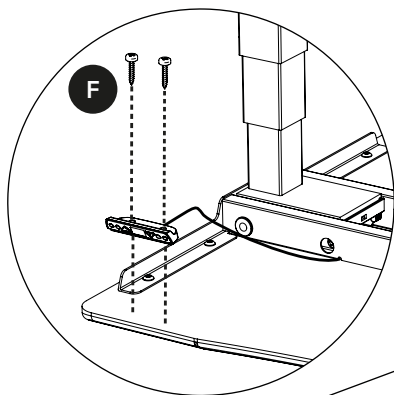

F

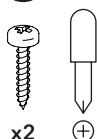

11

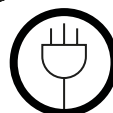
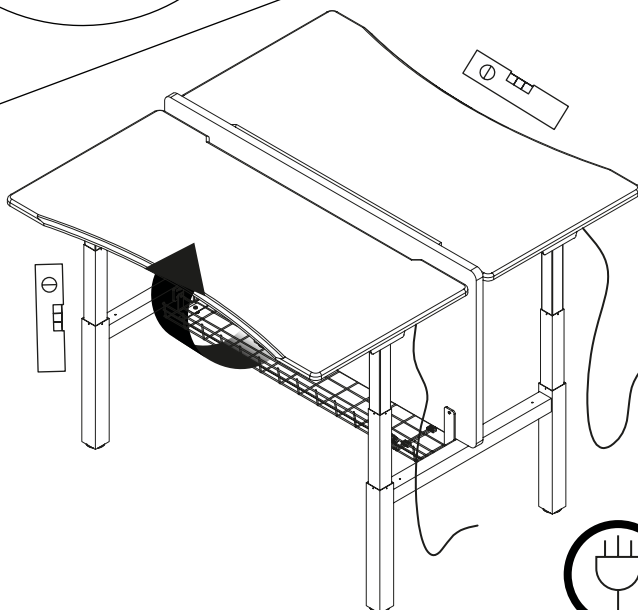
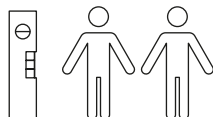
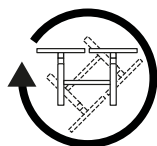

CONNECT  
TO POWER

12

## PERFORM COLUMN RESET:

- Press and hold both ▲ ▼ buttons.
- Continue pressing the buttons until both columns are in there Lowest position.
- When reset is finished the control box makes a sound and the buttons can be released.

**THE SYSTEM IS NOW OPERATIONAL**

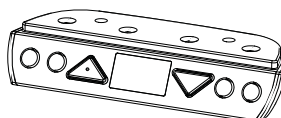
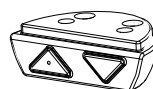

# 13 OPTIONAL SCREEN HOLDER

(Suitable for all Bench Desks)

G



x8



10

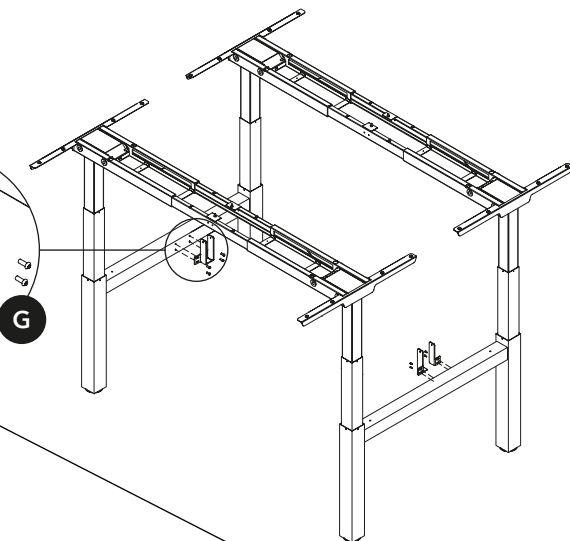

G

14

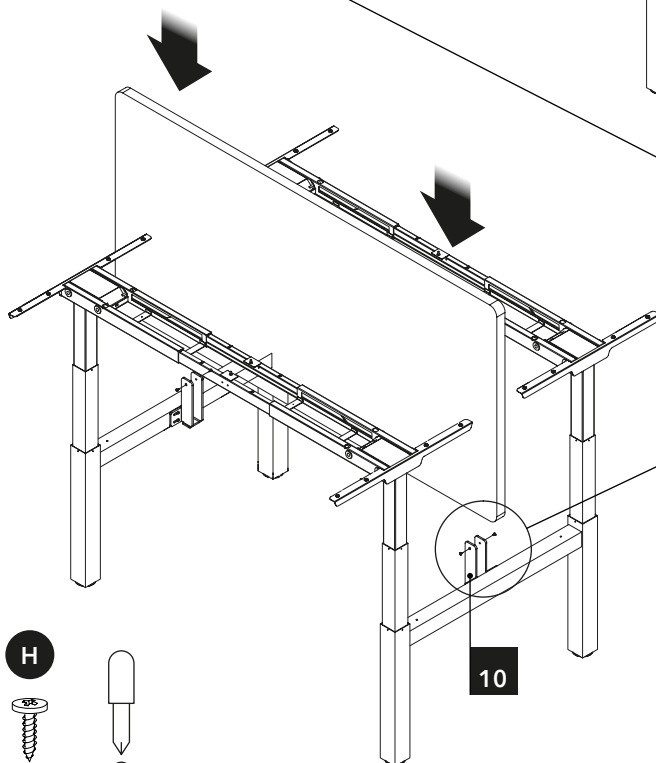

H



x4



+

10

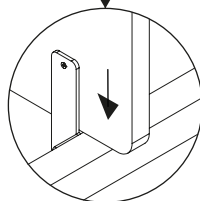
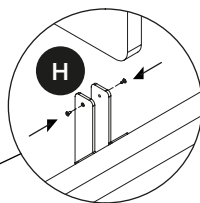

# 15 OPTIONAL CABLE TRAY

(Suitable for all Bench Desks)

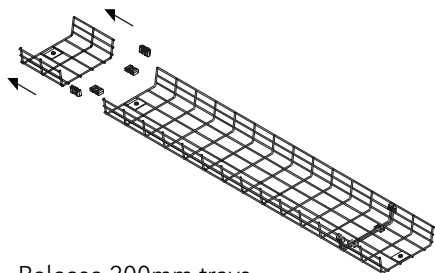

Release 200mm trays  
to fit 1200/1400/1600 Tops

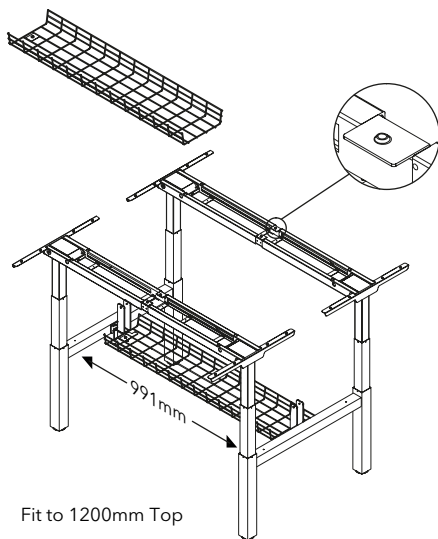

Fit to 1200mm Top

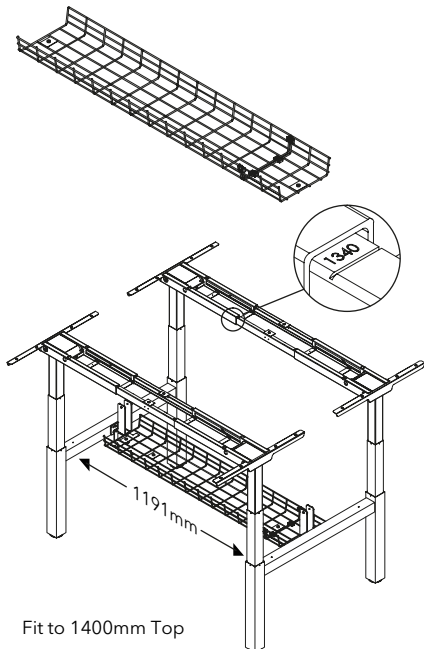

Fit to 1400mm Top

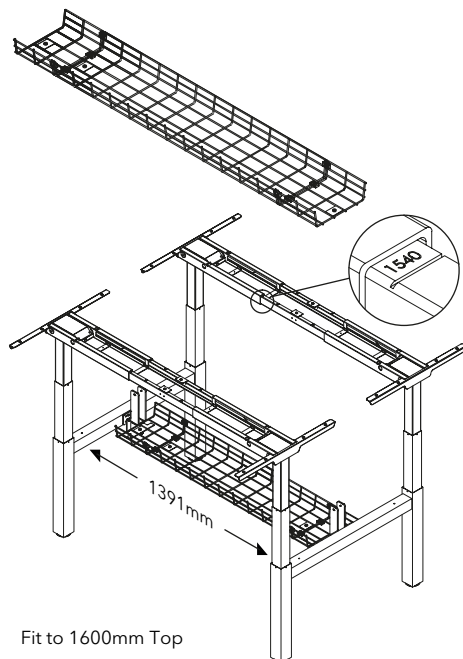

Fit to 1600mm Top

16

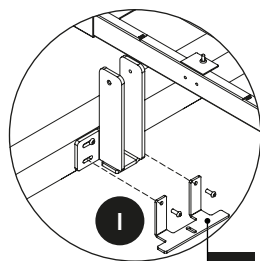

11

I



x4

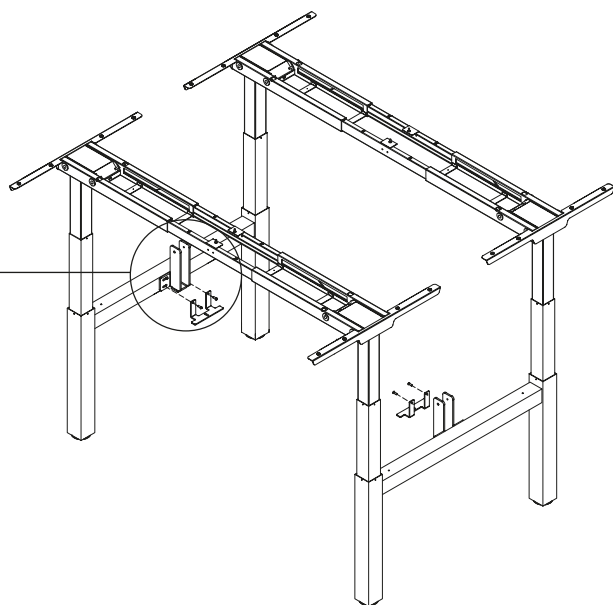

17

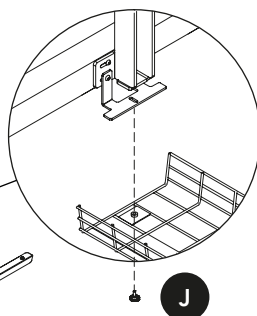

J

12

J



x2

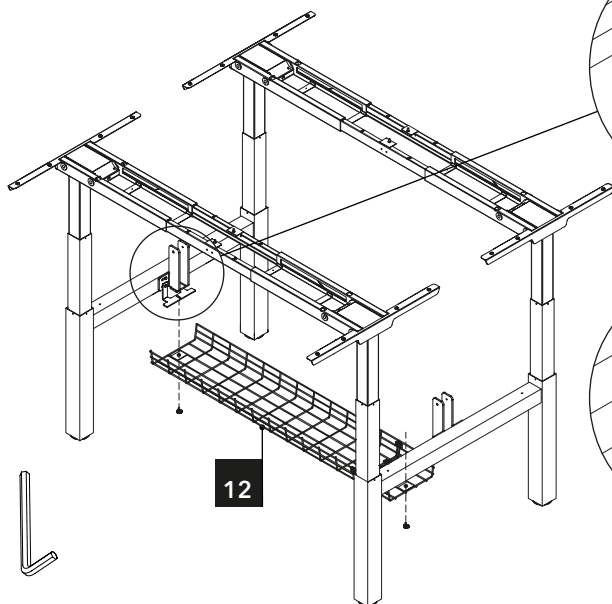

18

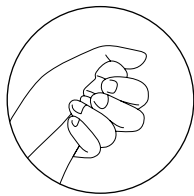

## CONGRATULATIONS!

We hope you enjoy your new desk. If you have any problems, call **08450 944 339**.

Send us a photo of your new desk or any feedback about your experience with Smart2Ergo to **[sales@smart2ergo.com](mailto:sales@smart2ergo.com)**.

For further info visit **[smart2ergo.com](http://smart2ergo.com)**.

**SMART2ERGO**  
flexibility • wellbeing • lifestyle



**SMART  ERGO**  
flexibility • wellbeing • lifestyle



for more info our website [www.smart2ergo.com](http://www.smart2ergo.com)  
call **08450 944 339** | email [sales@smart2ergo.com](mailto:sales@smart2ergo.com)

Hamilton Office Park, 5 High View Close, Hamilton, Leicester, LE4 9LJ, UK  
Company no. 778 5384 | VAT no. 228 6570 87 | part of **ksf supply ltd**

